

Name.....Adm No.....Stream.....

METALWORK

School.....

445/2

PAPER 2

FORM 4

JULY 2024

2½ hours

NYAHOKAKIRA CLUSTER TWO 2024

Kenya Certificate of Secondary Education

2½ hours

Instructions to Candidates

- (a) Write your name, admission number and class in the spaces provided above.
- (b) Students should have the following for this examination;
Drawing instruments;
Scientific calculator;
Drawing paper.
- (c) This paper consists of **two** sections: **A** and **B**.
- (d) Answer **all** the questions in section **A** in the spaces provided.
- (e) Answer **question 11** on drawing paper and any other **three** questions from section **B** in the spaces provided.
- (f) All dimensions in millimeters unless otherwise stated.
- (g) This paper comprises of **15** printed pages.
- (h) Candidates should check the question paper to ascertain that all the pages are printed as indicated and that no questions are missing.
- (i) Candidates should answer the questions in English.

For Examiners use only

| Section | Question | Maximum Score | Candidate's Score |
|-------------|----------|---------------|-------------------|
| A | 1 - 10 | 40 | |
| B | 11 | 15 | |
| | 12 | 15 | |
| | 13 | 15 | |
| | 14 | 15 | |
| | 15 | 15 | |
| Total Score | | | |

SECTION A (40 marks)

Answer **ALL** questions in this section in the spaces provided.

1. (a) Name **ONE** solvent commonly used in paints. **(1mark)**

.....

- (b) State **TWO** causes of burns in a workshop. **(1mark)**

.....

.....

2. (a) List **FOUR** uses of steel rule. **(2marks)**

.....

.....

.....

.....

- (b) (i) Use a sketch to show how strength of a butt joint can be increased when brazing.

(2marks)

- (ii) State **TWO** uses of a dot punch. **(1mark)**

.....

.....

3. (a) State **FOUR** safety precautions to be observed when using sheet metal. **(2marks)**

.....

.....

.....

.....

(b) Using a good sketch, show how an odd-leg calipers is set for a given measurement.

(2marks)

4. (a) State the rivet material which could be used to rivet a pan handle made of aluminium and state the reason for your choice **(1mark)**

.....

.....

(b) State **TWO** effects of each of the following alloying elements on iron; **(3marks)**

(i) Chromium

.....

(ii) Manganese

.....

(iii) Nickel

.....

5. (a) Define the term **'upsetting'** as used in forging. **(1mark)**

.....

.....

(b) State **TWO** reasons for twisting metal bars. **(2marks)**

.....

.....

6. (a) Explain each of the following terms as used in forging: **(3marks)**

I. Piping

.....

.....

.....

II. Necking

.....

.....

.....

III. Hardie

.....

.....

(b) State **THREE** types of cold chisel and give **one** use for each case. **(3marks)**

.....

.....

.....

.....

7. (a) State the;

I. Effect of prolonged heating in brazing **(1mark)**

.....
.....

II. Reason for concentrating heat on the thicker piece of metal when brazing two metals. **(1mark)**

.....
.....

(b) With reference to arc welding;

I. Define the term 'tack welding' **(1mark)**

.....
.....

II. State the use of tacks **(1mark)**

.....
.....

8. With the aid of labeled sketches, distinguish between turning and facing in lathe work.

(3marks)

9. State **FOUR** safety precautions to be observed in a metal workshop. **(2marks)**

.....

.....

.....

.....

10. (a) State **THREE** specifications of a hacksaw blade. **(1½marks)**

.....

.....

.....

(b) Name **THREE** types of cold chisels and give one use of each. **(3marks)**

.....

.....

.....

.....

.....

(c) List **FIVE** operations that can be performed on a drilling machine. **(2½marks)**

.....

.....

.....

.....

.....

SECTION B (60 marks)

Answer **question 11** on **A3** paper and any other **three questions** from this section in the spaces provided. Candidates are advised to spend not more than **25 minutes** on this **question 11**.

11. **Figure 1** shows a block draw in First angle projection. Draw in **full size** the isometric projection of the block. (15marks)

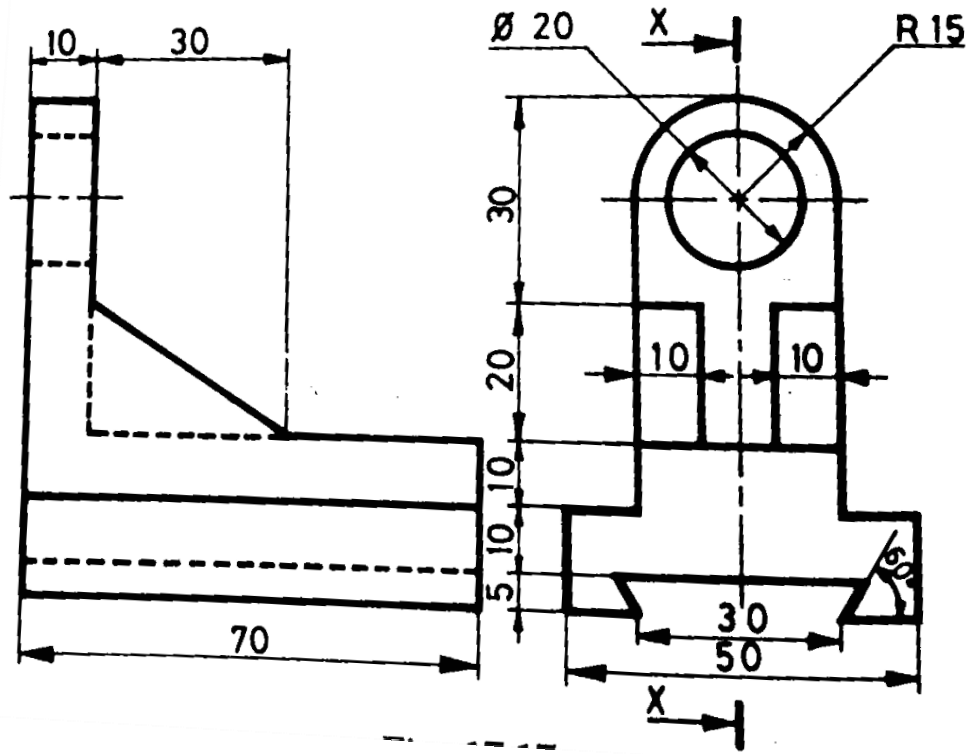

Figure 1

12. (a) With the aid of sketches, explain the procedure of drilling a hole on a centre lathe.

(10marks)

(b) State and sketch **TWO** methods of producing a short taper on a lathe machine.

(5marks)

13. (a) **Figure 2** shows a drawing of a bench drilling machine.

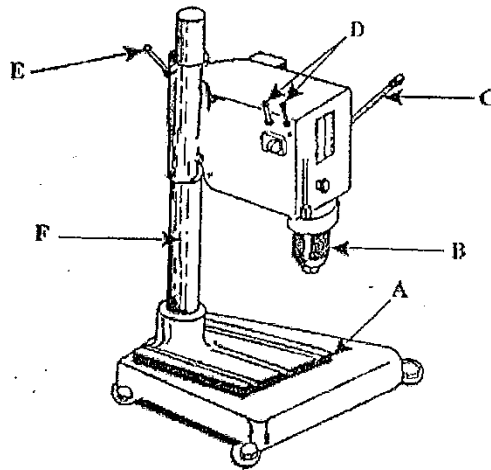

Figure 2

a) Name the parts labeled **A, B, C, D, E, and F** and state one function of each. **(6marks)**

.....

.....

.....

.....

.....

.....

.....

.....

.....

b) Outline **three** safety precautions to observe when using the machine. **(3marks)**

.....

.....

.....

c) Explain the relationship between the following; **(6marks)**

i. Speed and feed

.....

.....

.....

ii. Speed and drill bit diameter

.....

.....

.....

iii. Feed and material

.....

.....

.....

14. (a) With the aid of sketches, describe each of the following methods of arc welding.

(8marks)

i. leftward welding

.....

.....

.....

.....

.....

ii. rightward welding

.....

.....

.....

.....

.....

(b) Give **THREE** common methods used in each of the following weld tests: **(3marks)**

i. Non-destructive

.....

.....

.....

.....

ii. destructive

.....

.....

.....

.....

(c) State **FOUR** advantages of using rightward welding method. **(4marks)**

.....

.....

.....

.....

.....

.....

15. (a) With the aid of sketches, describe each of the following welding defects:

i. Lack of fusion

.....
.....

ii. Porosity

.....
.....

iii. Poor penetration

.....
.....

iv. Undercut

.....
.....

(b) Explain **TWO** possible causes of each of the defects in 13(a). **(4marks)**

.....
.....
.....
.....
.....
.....
.....
.....
.....
.....

(c) State the effects of the defects in each case.

(4marks)

.....

.....

.....

.....

.....

.....

(d) State **ONE** general and common cause of welding defects.

(1mark)

.....

.....

.....

THIS IS THE LAST PRINTED PAGE